

TO: SWALE JOINT TRANSPORTATION BOARD

DATE: MONDAY 15TH DECEMBER 2008

SUBJECT: VARIOUS WAITING RESTRICTIONS – CONSULTATION RESULTS

BY: Head of Amenities

Classification: Unrestricted

Summary: Members to consider the results of recent consultation exercises carried out in various locations in relation to new waiting restrictions

Decision Required: That Members note the report and recommend that the following waiting restrictions are implemented:

- Church Street/Millen Road/Charlotte Street, Sittingbourne
- Yeates Drive junction with Todd Crescent, Sittingbourne
- Bus Clearway, Rushenden Road, Queenborough

That Members note the report and recommend that the following restrictions are not implemented:

- Springhead Road, Faversham
- Railway Terrace, Queenborough

The consultees are notified accordingly

Introduction

1. A consultation has been undertaken with residents and statutory consultees in relation to the introduction of new waiting restrictions within the Borough. These proposals have come from various sources such as residents' letters, parish/town council correspondence, residents' petitions and PACT meetings.

2. The plans of the proposed restrictions have been included in Annex A

Discussion

3. The objections from the consultations have been included within Annex B. Each of the locations will be discussed in turn in the following paragraphs. Where corner protection measures are being introduced, Kent Police have requested that a minimum waiting restriction distance of 10 metres should be adopted. However, in

areas where parking demand is high this will greatly reduce local parking capacity. The proposals for corner protection in this report do meet the requirement where possible; however, in some locations the need for a waiting restriction has been balanced against the need for parking, so in some instances the corner protection may have been reduced to 5 metres.

4. Church Street Junction with Millen Road/Charlotte Street, Sittingbourne

A resident of Church Street informed us that there was a problem with vehicles parking on or close to the junction of Church Street, Millen Road and Charlotte Street, making visibility poor and affecting safe vehicle movements at the junction.

A consultation took place proposing corner protection in the form of double yellow lines to improve the current problems. Of the consultation letters sent out, 4 supported the proposals, 1 objected and 0 were undecided. It is therefore recommended that the restrictions be installed, as they will improve visibility and vehicle movements at the junction of Church Street, Millen Road and Charlotte Street. Comments from the consultation are included in Annex B.

5. Yeates Drive junction with Todd Crescent, Sittingbourne

A resident informed us that vehicles were parking on the junction of the above road, making visibility poor and affecting safe vehicle movements.

A consultation took place proposing corner protection in the form of double yellow lines at the above location. Of the consultation letters sent out 5 supported the proposals, 2 objected and 1 were undecided. It is therefore recommended that the restrictions be installed, as they will improve visibility and vehicle movements at the junction of Yeates Drive and Todd Crescent. Comments from the consultation are included in Annex B.

6. Springhead Road, Faversham

A request for parking restrictions on one side of Springhead Road was requested by the Kent Fire Brigade due to recent problems accessing an emergency call. The reported problem happened in the area of 34 Springhead Road. The Fire Brigade had to get two vehicles moved to get past. The problem only seems to occur when vehicles park on both sides of the road.

A consultation has been carried out in regards to double yellow lines on the northern side of the carriageway at the above location. Of the consultation letters sent out 16 supported the proposals, 13 objected and 2 were undecided. Due to the amount of objections received it is recommended that these proposals are not implemented at this time but a discussion is held with Kent Fire Brigade in regards to a limited section of yellow lines being installed to help access but keep available parking to a maximum. The proposed restrictions may displace parking creating problems in neighbouring roads. Kent High Services were consulted and they suggested that if the restrictions were installed they should be staggered to create a chicane effect creating a natural speed restraint. Comments from the consultation are included in Annex B.

7. Railway Terrace, Queenborough

A request was received from a shop owner of Railway Terrace for a 20 minute waiting limit to be introduced in the layby outside of No.1-5 Railway Terrace, to allow customers to park whilst visiting the shops but preventing other vehicles parking for longer periods of time. This follows the removal of out of date and unenforceable restriction signs by our Parking Control Section.

A consultation has been carried out with residents in the area and other formal consultees. Of the 14 residents and shop owners consulted, 4 responded, 3 objecting to the proposals and 1 supporting. In addition to this, our Parking Control Section stated that *"Queenborough is a village which will only get patrolled once a day. To have 20 minute bays where the shops are is going to prove hard to keep enforced."* Full comments from the consultation are included in Annex B.

8. Rushenden Road, Queenborough

Following a request made at a PACT Meeting in Queenborough, a consultation took place with residents and other formal consultees to install a bus clearway at the bus stop opposite the Trafalgar Hotel, to keep the layby clear of parked vehicles to enable the bus to pull in and stop without hinderence.

Of the 13 residents consulted, 2 responded, 1 supporting the proposals and 1 objecting. The objection was on the grounds that the "bus lane" would cause congestion at the top of Rushenden Road, but as the proposals only consist of restricting parking in the bus layby it is felt that this will improve the movement of traffic by allowing buses to pull out of the live carriageway into the layby to stop.

Recommendation

9. Members are asked to note the comments/objections made by the consultees and recommend that the following waiting restrictions are installed and that the consultees are notified accordingly.

- Church Street junction with Millen Road/Charlotte Street, Sittingbourne
- Yeates Drive junction with Todd Crescent, Sittingbourne
- Bus clearway, Rushenden Road, Queenborough

8. Members are asked to note the comments/objections made by the consultees and recommend that the following waiting restriction is not installed and a further consultation progress if problems persist. A discussion is to be held with Kent Fire Brigade in regards to Springhead Road. Consultees are to be notified accordingly.

- Springhead Road, Faversham
- Railway Terrace, Queenborough

Author - Ext. Brett O'Connell 01795 417061

Date: 20th November 2008

List of background documents – Consultation Plans, Annex A
Consultation Comments, Annex B



Proposed Amendments to Parking Restrictions Railway Terrace, Queenborough

Following a request from a local shop owner, Swale Borough Council are proposing to amend the existing waiting restrictions in Railway Terrace, Queenborough as shown on the plan overleaf.

The proposals consist of installing a waiting restriction of 20 minutes in the layby outside of Nos. 1 to 5 Railway Terrace, to allow customers to park whilst visiting the shops. The restrictions will only apply between 8:00am and 6:00pm Monday to Saturday.

If you support or object to the proposal please complete the slip below and return to the Borough Council before Friday 21st November 2008 in the pre-paid envelope provided. A space has also been provided to allow you to add any further comments you may have.

Proposed Amendments to Parking Restrictions – Railway Terrace, Queenborough

Please tick one of the following boxes

I Support the proposal to amend the parking restrictions as shown above

I Object to the proposal

Name & Address	Comments

The information supplied will only be used in conjunction with this proposal, and used for geographical analysis purposes only

Plan of proposed restrictions

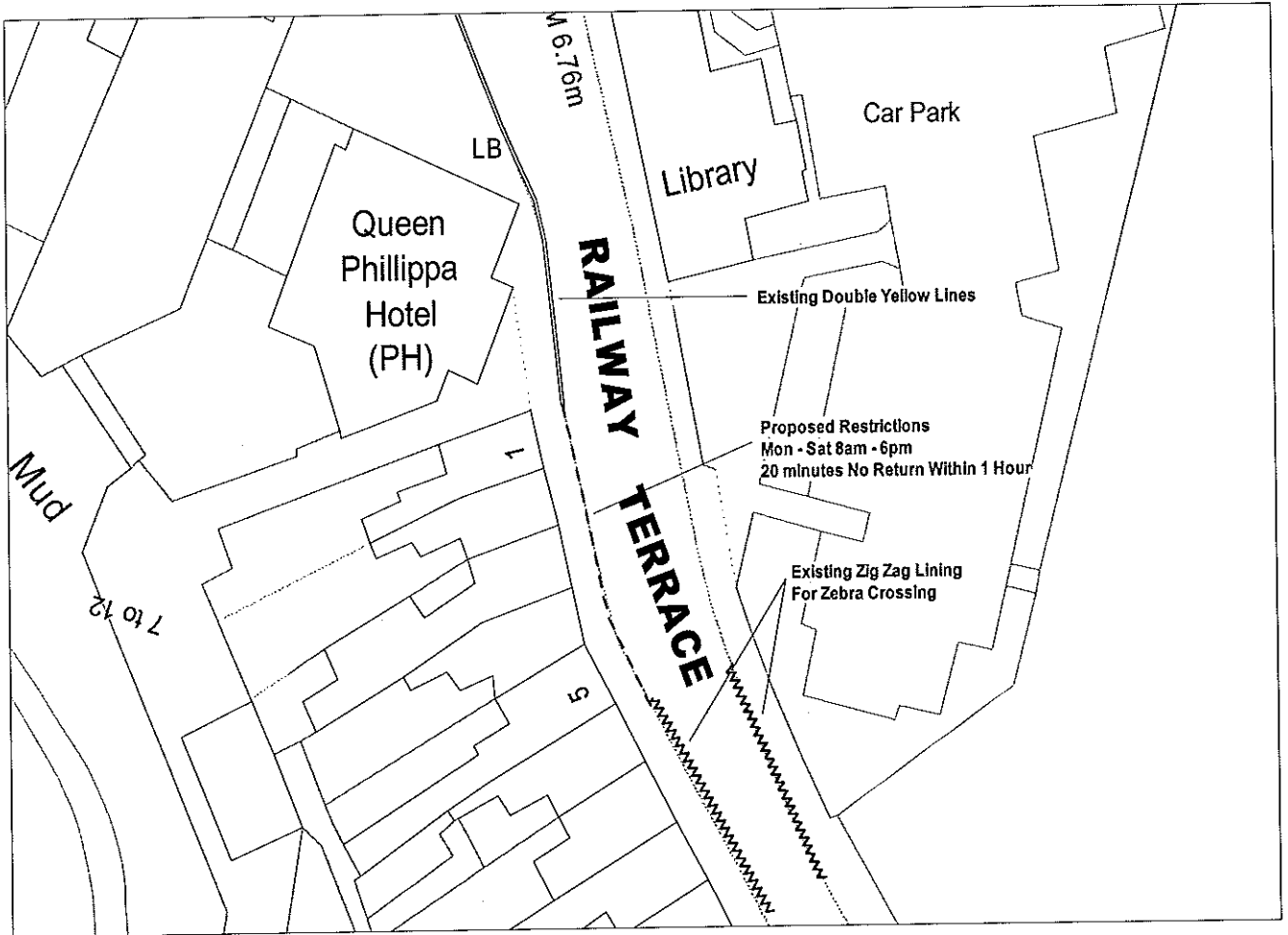

Proposed Bus Clearway Rushenden Road, Queenborough

Following requests from residents at previous PACT meetings, the Borough Council are planning to install a bus clearway at the bus stop opposite the Trafalgar Hotel in Rushenden Road, Queenborough.

The proposals consist of installing lining and signing to keep the layby clear of parked vehicles, as shown on the plan overleaf. These restrictions will enable buses to pull into the layby without obstruction, and without hindering the movement of vehicles along Rushenden Road.

If you support or object to the proposal please complete the slip below and return to the Borough Council before Wednesday 19th November 2008 in the pre-paid envelope provided. A space has also been provided to allow you to add any further comments you may have.

Proposed Bus Clearway – Rushenden Road, Queenborough

Please tick one of the following boxes

I Support the proposal to install a bus clearway as shown

I Object to the proposal

Name & Address	Comments

The information supplied will only be used in conjunction with this proposal, and used for geographical analysis purposes only

Plan of proposed bus clearway

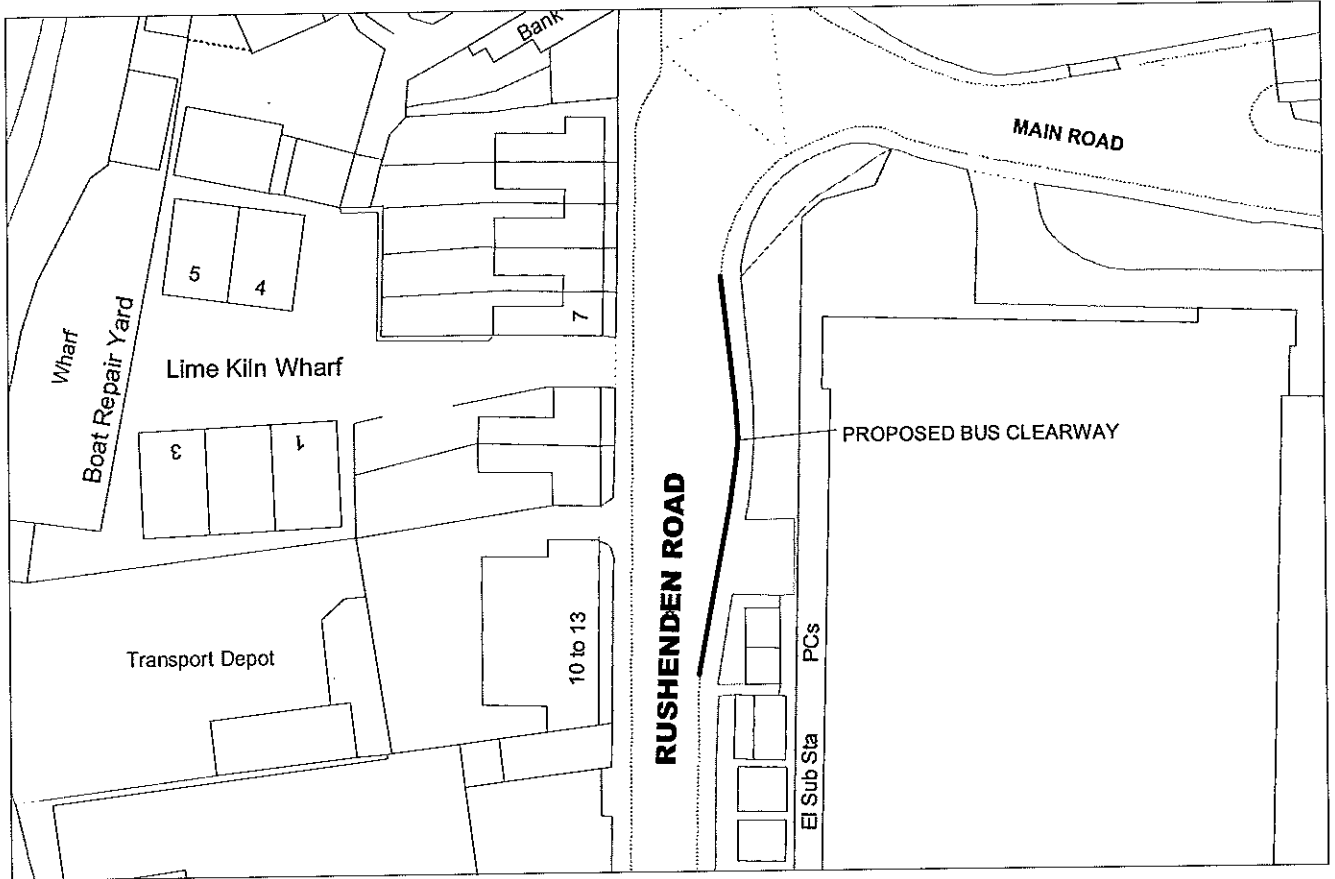

ANNEX A



Her Majesty's Stationery Office (HMSO) Crown Copyright. Unauthorised reproduction in any form without the permission of HMSO is prohibited. Swale Borough Council, LA079626, 2001



DRAWN	BOC
DATE	Oct 08
SCALE	NTS
ES/2738/35	

<p><u>Key</u></p> <p>==== Proposed Double Yellow Lines</p>
<p>Springhead Road, Faversham - Proposed Double Yellow Lines.</p>

ANNEX A

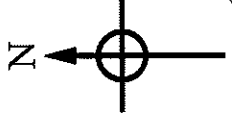
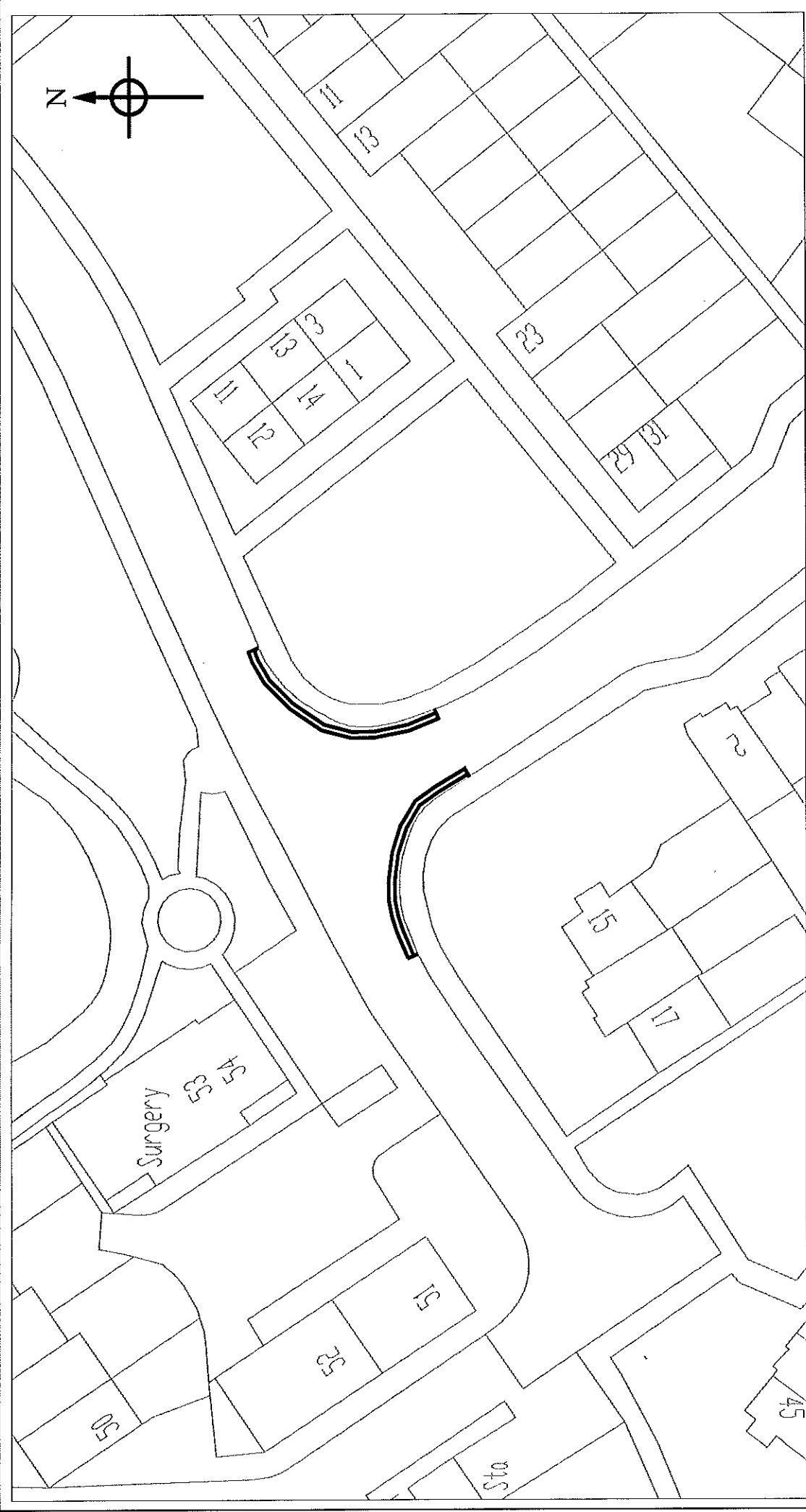



Swale
 BOROUGH COUNCIL
NORTH KENT COAST

His Majesty's Stationery Office (HMSO) Crown Copyright. Unauthorised reproduction infringes Crown Copyright and may lead to prosecution without notice.
 Swale Borough Council, LA079636, 2001

DRAWN	BOC
DATE	Oct 08
SCALE	NTS
ES/2738/65	

Key

Proposed Double Yellow Lines

**Yeates Drive/Todd Crescent, Sittingbourne -
 Proposed Waiting Restrictions**

ANNEX A

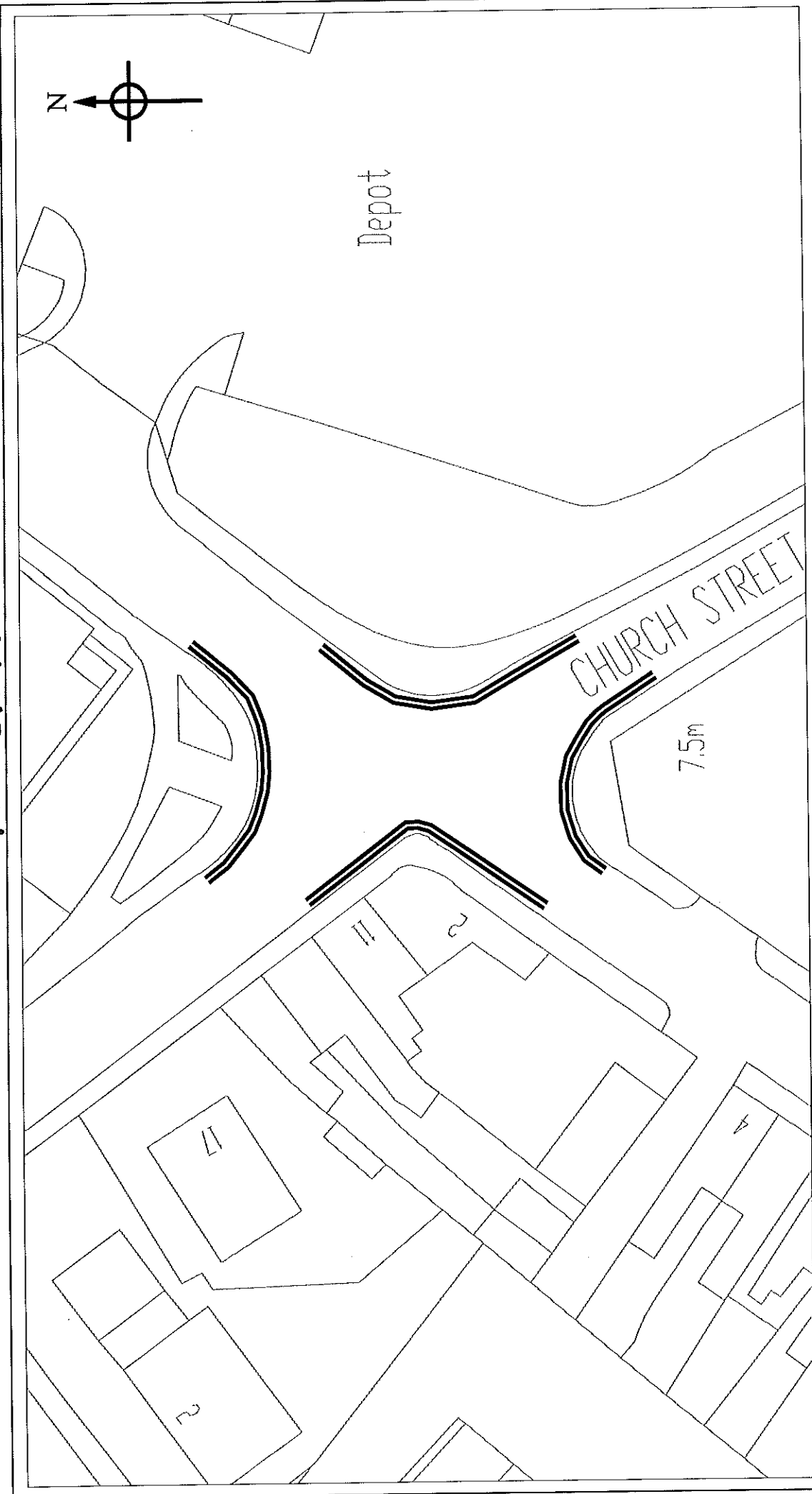

Her Majesty's Stationery Office (HMSO) Crown Copyright. Unauthorised reproduction infringes Crown Copyright and may lead to prosecution or civil proceedings.
Swale Borough Council, LA079666, 2001.



Key	DRAWN	BOC
	DATE	Oct 08
	SCALE	NTS
<p>  Proposed Double Yellow Lines </p>		ES/2738/66
<p> Church St/Millen Road/Charlotte St, Sittingbourne - Proposed Waiting Restrictions </p>		

Church Street junction with Millen Road/Charlotte Street, Sittingbourne

Recommendation - Approval

Resident Ref No.	Support	Object	Undecided	Comments
1	1			Better for residents if we had a 2 hour time limit as well as double yellow lines
2	1			No Comment
3		1		What are you trying at achieve? Not aware of any accidents. It is impossible to park outside home because commuter traffic, this will make it worse
4	1			No Comment
5	1			Suggest potholes are repaired before double yellow lines are painted. Lines should extend to No 13
TOTAL	4	1	0	

Yeates Drive junction with Todd Crescent, Sittingbourne

Recommendation - Approval

Resident Ref. No.	Support	Object	Undecided	Comments
1	1			No Comment
2		1		Lived here 7 years with no problems. People do not park right on the corner. Partner has to put work van on the road so putting double yellow lines there will cause problems if they go this far down
3	1			No Comment
4		1		Rather than parking restrictions perhaps 20 mph speed limit would be more prudent. Restrictions on parking would frustrate the residents
5	1			Very good idea, should have been done a long time ago
6			1	Proposed area for double yellow lines, cars do not park there. Have marked on the map problem areas
7	1			Evening and weekends people visit the lake parking wherever they

									want to and on footways; this also reduces the road to single file traffic. Indicated on map affected area.
									I rang council couple of weeks ago to suggest this and was told it was a waste of time and council could not monitor the people who ignore the lines. Double yellow lines in North Street, no one takes any notice. I see near accidents all day with people parking all around the car park and lake. Cars should slow down around here. When the lake was re-opened I was told that no cars would park in Todd Crescent but park in Newman Drive. Feel a white line across Yeates Drive would slow the traffic down
8		1							
TOTAL		5	2	1					

Springhead Road, Faversham

Recommendation – Refusal

Resident Ref. No.	Support	Object	Undecided	Comments
1	1			Very good idea
2	1			No Comment
3	1			No Comment
4	1			No Comment
5	1			No Comment
6	1			No Comment
7	1			No Comment
8		1		No Comment
9	1			No Comment
10		1		There will be no where to park my car
11	1			No Comment
12	1			No Comment
13	1			Can the yellow lines come round Fostall Road a little bit more
14			1	Will our parking spaces in Brook Road vanish to accommodate the extra cars from Springhead? It is bad enough now

15			1	Because of yellow lines all cars will be parked on my side of road. Am disabled, can only walk a few yards. Age Concern pick me up everyday, I need a space outside property to reach the bus. How will I manage with all the parked cars?
16	1			Agree parking is ridiculous and road difficult, marking the north side will cause more problems. There are more driveways on the south side and spaces available on the north side so it would make sense to line the south side
17			1	sounds ok but we do not have enough spaces for parking
18			1	Object to lines on North side. Would support if on south side due to drop kerbs
19			1	Comments as 18. would leave with many residents with nowhere to park or obstruct driveways
20			1	Most of north side do not have off street parking. Suggest mounted pavement parking on both sides
21			1	Should be south side. How will it be policed? Caravan parked for 3 months taking up spaces
22			1	Large grass area next to the park could accommodate 8+ cars or offer cut price drop kerbs
23		1		Why have we had this problem for the last 5 years?
24			1	Where are we supposed to park on this side of the road? Will not be of use to emergency services. No 37 has 5 cars parked at a time. Am non-driver disabled person who can not have son's car parked in the disabled bay by No 46, but No 43 parks works van in the bay or on the footway outside my house
25		1		Thoroughly agree with proposal. We have caravans, lorries and cars parked on the footway forcing people to walk in the road. Housing assoc could lower the footway to allow off road parking
26			1	Better to put on south side, will stop parking on footway and wouldn't need double yellow lines. Can you get the caravan moved
27			1	South side not north. Marked the map to show drop kerbs
28			1	Strongly object, you will push the traffic onto Forstal Road and Larksfield Road, where do we park? Unless you have

				alternative area for parking it is best left alone.
29	1			Solely because lines will be on wrong side of the road. Repeats above comments. Tenant with caravan also has car and open backed lorry. Disabled bay outside 44 and 46 for tenant of 37 died a few years ago
30	1			Wholeheartedly support but what happens to residents having to park in surrounding area. Could the Council assist with drop kerbs or a rear parking area
31	1			Paid for dropped kerb 9 years ago. Comment about No 50 with caravan, car and lorry. Comment about 39 with truck and car parked on dropped corner of Fostal Road
TOTAL	16	13	2	

Bus Clearway – Opposite Trafalgar Hotel, Rushenden Road, Queenborough

Recommendation - Approval

Resident Ref No.	Support	Object	Undecided	Comments
1	1			No Comment
2		1		very few people use the bus stop. Bus lane would cause unnecessary congestion at the top of Rushenden road. The layby is big enough for the buses
TOTAL	1	1	0	

Amendments to Parking Restrictions – Railway Terrace, Queenborough

Recommendation - Refusal

Resident Ref No.	Support	Object	Undecided	Comments
1		1		No Comment
2		1		Car park across from shops should be made bigger because there is never enough room. Make secure with CCTV cameras that work properly
3		1		Concerned modifications to car park may mean insufficient parking for residents
4	1			No Comment
TOTAL	1	3	0	